

Product Datasheet

CPH2010

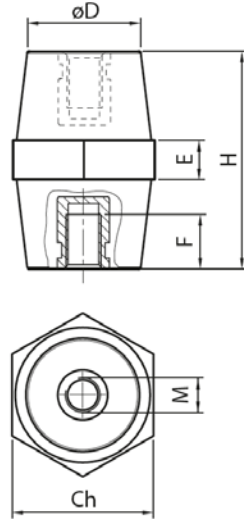

Main

Family	Low voltage insulators	
Version	Insulators in polyester	
Code	CPH2010	
Reference	CPH 20M6	
Number per package	25	
Weight (kg)	0.012	
Dimensions (mm)	H=20 Ch=19 D=16 E=5 F=6	
Type	Hexagonal	
Thread Size	M6	
Force Characteristics	Tightening torque*	8 Nm
	Tensile strength	2.4 kN
	Compressive strength	20 kN
	Flexural strength	2.4 kN

*Maximum tightening torque value suggested for 8.8 class screws

Technical Characteristics

Insulation

Thermosetting polyester reinforced with fiberglass

Self-extinguishing: UL94-V0

Color: red RAL 3031

Threaded Inserts

Galvanized steel

Finished product

Rated voltage: 1000 V AC/1500 V DC

Working temperature: -40 ÷ 130 °C

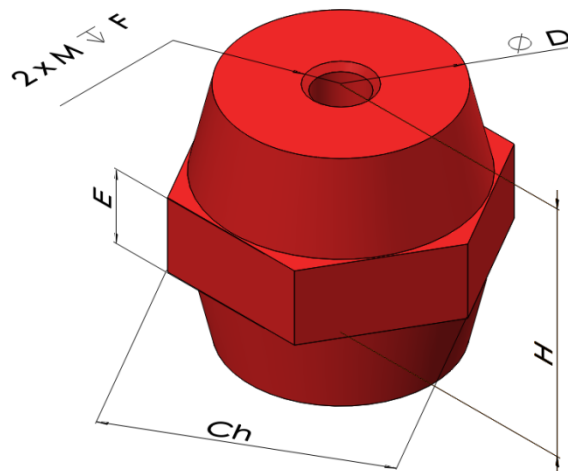

Please contact Teknomega for non-specified tolerances