

## Product Datasheet

### CPH2005

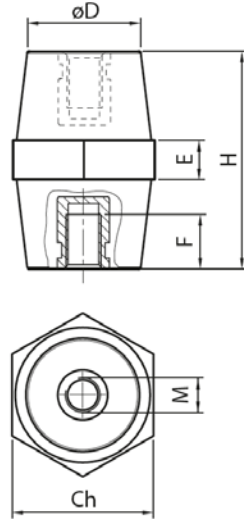

#### Main

Family	Low voltage insulators	
Version	Insulators in polyester	
Code	CPH2005	
Reference	CPH 20M4	
Number per package	25	
Weight (kg)	0.14	
Dimensions (mm)	H=20 Ch=19 D=16 E=5 F=6	
Type	Hexagonal	
Thread Size	M4	
Force Characteristics	Tightening torque*	3 Nm
	Tensile strength	2 kN
	Compressive strength	20 kN
	Flexural strength	1.5 kN

\*Maximum tightening torque value suggested for 8.8 class screws

## Technical Characteristics

### Insulation

Thermosetting polyester reinforced with fiberglass

Self-extinguishing: UL94-V0

Color: red RAL 3031

### Threaded Inserts

Galvanized steel

### Finished product

**Rated voltage:** 1000 V AC/1500 V DC

**Working temperature:** -40 ÷ 130 °C

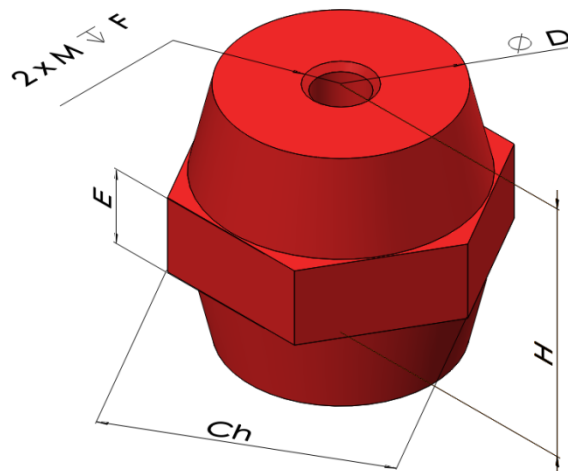

Please contact Teknomega for non-specified tolerances.