

Product Datasheet

BOC1005

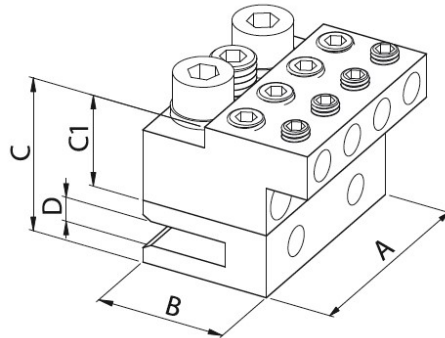

Main

Family	Accessories for busbars
Version	Direct hook-up distribution block on copper busbars
Code	BOC1005
Reference	BOC KIT 8 – 5 *
Number per package	12
Weight (kg)	0.39
A (mm)	50
B (mm)	30
C (mm)	37
C1 (mm)	22
D (mm)	5
Torque (Nm)	See table and note below

*8 output distribution block unit + connection unit on 5 mm thick bar

Technical Data

Code	IN/OUT	Stripped cable sect. (mm ²)	Cable with ferrule sect. (mm ²)	Nr	∅ (mm)	Torque (Nm)	Screw
BOC1005	← OUT	2.5 ÷ 25	2.5 ÷ 16	4	7	3	M6
	← OUT	4 ÷ 35	4 ÷ 25	4	9	6	M8

Technical Features

Material: brass

Up to 400 A

Compliant with standard **IEC 60947-1**

Note: M8 screws are to be tightened with a torque of 6 Nm. M10 screws are to be tightened with a torque of 10 Nm. Hardware included.

Advantages

BOC1005 allows direct connection on prepunched, threaded or solid bars with two different installation configurations. The distribution block can be attached to 5 mm thick bars.

Simple and quick derivations with cables up to 25 and/or 35 mm² that can be used up to 400 A.

The connection units allow spacing of drilled bars of the same phase.

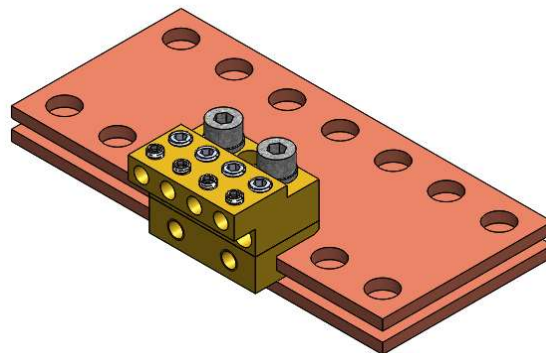

Use of BOC1005 on BRP1015 (pre-punched copper bars)

Two mounting possibilities

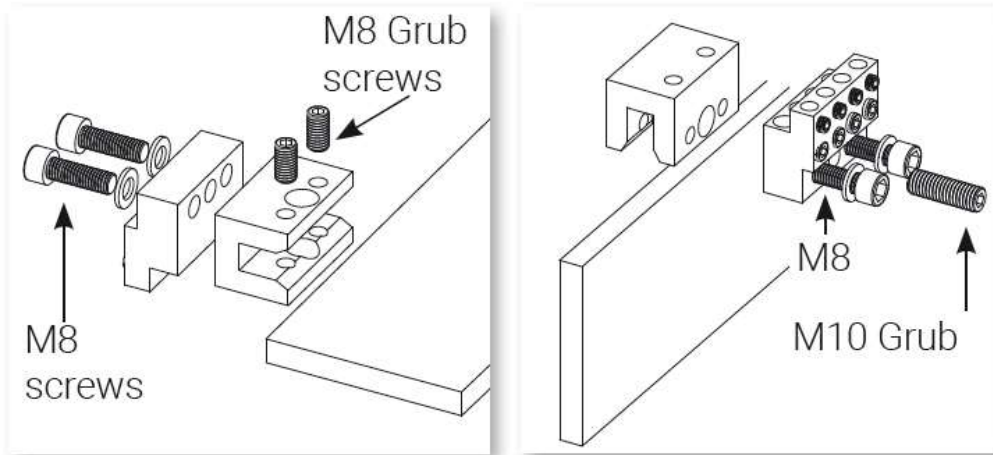

Use with solid bar

- use both the units
- two mounting possibilities

Use with prepunched bar

- use only the distribution block unit on single bar phase systems.
- use both units on multi bar phase systems



BOC1005

Please contact Teknomega for non-specified tolerances.